

P156Z

Double connector DN 40/32 x Ø 8-23 mm for connecting washing machine and dryer to trap, with non-return valves

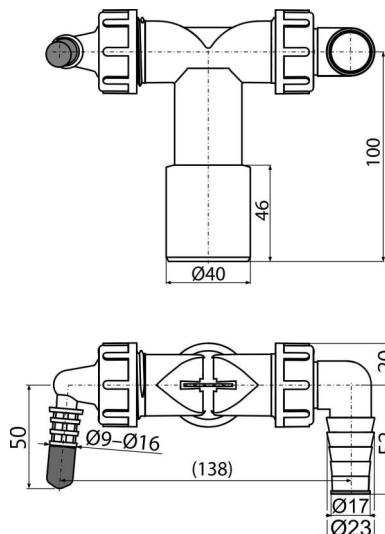

Application

For washing machines and other traps
Connects various appliances to the waste pipe
For the connection of up to two appliances

Features

- Two connectors for various electrical appliances – washing machines, dishwashers, dryers, boilers, air conditioning, heat recovery, etc.
- Direct connection to HT DN40/DN32 – no need of another trap when installing additional household appliance
- Valves with partition serve to direct the flow of water into the waste
- The red plug is used for blinding the connector if it is not used.
- Material: polypropylene

Scope of supply

- Connector body
- Elbow 17-23 mm - 1 pc, Elbow 8-16 mm 1 pc
- Seal
- Plug 1 pc
- Connector seals 2 pcs
- Return valve 2 pcs

Order number, Logistic information

Code	EAN	Weight (piece packing palett)	Dimensions (piece packing)	Quantity (packing palett)
P156Z	8595580562519	0,11 5,53 174,7 kg	125x72x94 590x390x240 mm	50 1400 pcs

Warranty

2/2 years *

Technical specifications

- Thread for connection to the trap 1 "
- Hose connector 8-16 mm
- Hose connector 17-23 mm